



Japanese Technology since 1912

## Standardised electric pumps

60Hz Product Catalogue





**Japanese Technology since 1912**

[www.ebara-europe.com](http://www.ebara-europe.com)

# Extraordinarily standardised

The centrifugal electric pumps standardised according to the EN733 standard, with axial suction and radial discharge, are the flagship of the EBARA products.

They stand out for the quality and reliability of the individual components, for the vastness of the range and for the variety of solutions offered.

The motors available for the various models that make up the range are energy efficient 2- or 4-pole motors.

The efficiency and reliability of the pumps is improved by the possibility of using the inverter technology systems present in the EBARA range in different types, for an energy and economic saving of the entire system and an improvement of environmental sustainability.

EBARA is a fundamental partner for the supply of pumping systems.

This is why it is important to supply not only the electric pumps, but also the complementary products for the system.

EBARA offers a wide range of accessories for standardised electric pumps, including: special seals, variable speed control systems, electrical panels, vessels and floats.

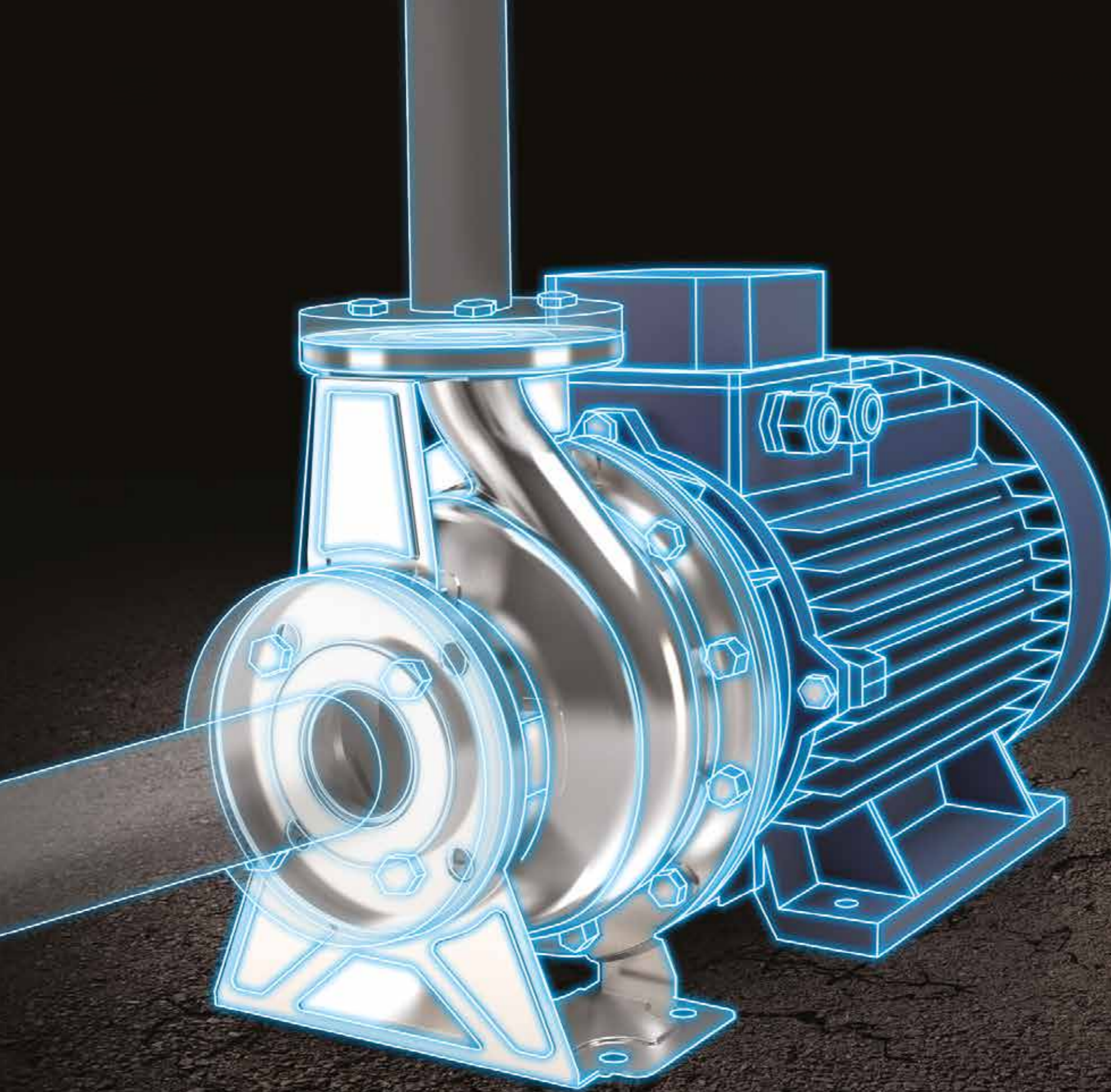

# Different needs, a unique range

Making a range complete means **combining** the different needs of the sectors in which the pumps will be used with **innovative, reliable, efficient** solutions to operate successfully, even in the most difficult and challenging of conditions.

The range consists of **3 SERIES**, available in AISI 304 or AISI 316 stainless steel in a monobloc version, with a rigid joint, with a flexible joint and also in the "Z version" with adjustable foot; then there is the **3D SERIES** standardised cast iron electric pump with AISI 304 impeller, also available with monobloc motor, rigid coupling, flexible coupling. Completing the 3D SERIES are the pumps of the **MD** series, monobloc electric pumps with elongated shaft and impeller in AISI 304 steel for the MD.

The **GS** electric pumps, the **new electric pumps** of EBARA that combine the best technical and performance characteristics in a single solution, integrate an already comprehensive range.

The use of different types of materials, the possibility of inserting special mechanical seals and at the same time the amplitude of the guaranteed performances make the standardised electric pumps a winning "team".

**A complete range.**



# Hydroforming molding core

High efficiency is one of the main features of the standardised pumps. Not only that, also the quality of the materials, the high performance and the corrosion resistance are among the strong points. To do all this, we focused on the particular production process of the pump body: **hydroforming**.

This process uses a high pressure fluid (up to 1200 bar) for metal forming. The hydraulic fluid, in our case water, with increasing pressure pushes the stainless steel to copy the shapes of the template until it comes into contact with the internal walls of the matrix that constitutes the mold. Hydroforming, which combines the power of a press with the power of water, has significant advantages over traditional processes: **perfectly smooth**, highly **flowing** and **without welding points**.

These features thus ensure high corrosion resistance, high efficiency with **efficiency of over 80%** and reduced losses.

For high efficiency and **high performance**.

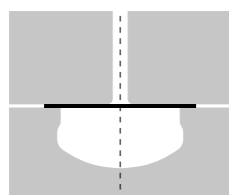

### CLOSURE

The steel disc is positioned in the press

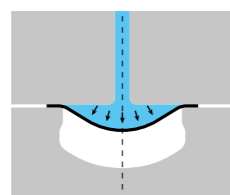

### FORMING

The water is injected into the mold at a pressure of 1200 bar

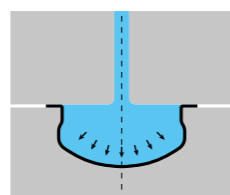

### COMPLETION

The water fills the whole mold, thus deforming the steel disc

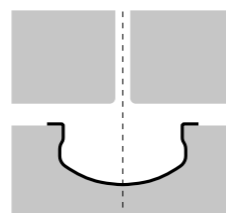

### EXTRACTION

The press is raised and the pump body is formed without welding points.



# Sectors and Areas of application

The range of EN733 standardised electric pumps is suitable for different types of use, from industrial applications to irrigation, from air conditioning and heating to washing systems and in all those applications that require reliability and efficiency as well as reduced cost management.



## Water supply

For water supply in civil, agricultural or industrial plants



## Pressurisation

For the pressurisation of water in residential, commercial, industrial and agricultural areas ensuring an efficient water supply



## Fire-fighting

For the creation of fire-fighting groups compliant with the European standard UNI EN 12845



## Irrigation

To make available the water necessary for crops



## Washes

For the creation of washing systems used in industry (car washing machines, dishwashers, cleaning in place, sterilizing in place)



## Air-conditioning

For the circulation of water in air conditioning systems



## Heating

For the circulation of water in heating systems



## Handling

Industrial liquid handling in process applications



## Swimming pools

For water recirculation of swimming pools or of sports facilities



## Refrigeration towers

For the circulation of water required in refrigeration towers



## Emptying

For the emptying of tanks



## Perfect interchangeability

### 3D SERIES - MD

Pump body made of cast iron EN-GJL-250-EN 1561 (fig. 1).

### 3 - 3L SERIES

The external structure has been tested at a pressure of 14 bar in a sequence of 1 million cycles, reinforced to withstand the stresses and strains of the system, high hydraulic efficiency thanks to the volute obtained by hydroforming.

Pump body made of AISI 304 for 3 SERIES and of AISI 316L for the 3L SERIES pumps, for the 65-250 pumps and the 80-160/200/250 pumps of the 3L SERIES, it is made of AISI 316 micro-cast (fig 2).



### Impeller

Hydraulically balanced to prevent axial thrusts against the seal, it achieves 80% efficiency.

Made of stainless steel AISI 304 for 3 SERIES - 3D SERIES - MD, in AISI 316 for the 3L SERIES - 3D 65.



# 3 - 3D - MD SERIES

### Back pull-out design

It allows removal of the motor, the coupling, the cantilever support and the impeller without compromising the housing of the pump body or removing the pipes.

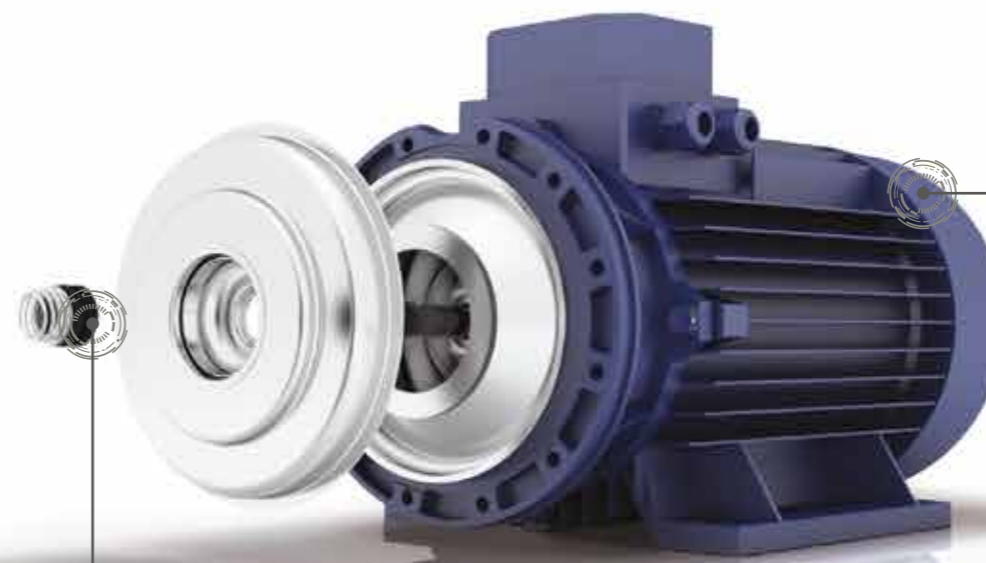
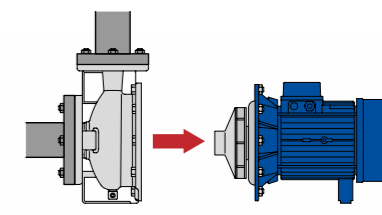

### Motor

2 pole for 3 and 3D Series,  
2 and 4 pole motors for GS Series

### Several options

The many types of mechanical seal that can be mounted on the electric pumps allow the use of special materials and therefore adapt to different needs based, for example, on the type of liquid, the temperature or other factors of use covering, depending on the models, the following temperature range:

- $-10^{\circ}\text{C} \div 90^{\circ}\text{C}$  for versions with standard seals
- $-20^{\circ}\text{C} \div 120^{\circ}\text{C}$  for versions with special seals

# MODEL GS

## Materials available for the impeller

All the GS family models are available with cast iron or bronze impeller to ensure the best solution for various applications.

## Back pull out design and shielded bearings

This configuration ensures disassembly and inspection of the pump without having to remove it from the system piping. Furthermore, the use of shielded bearings eliminates the need to add or replace lubricating oil. This solution facilitates and speeds up maintenance.



## Bare axis pump and electric pump

GS models are available both in the bare axis version and in the electric pump version, with motor powers up to 355 kW. The available motors are 2 or 4 poles, 60 Hz, coupled with inverter.

## Features of the pump body

Cast iron, complying with the EN733 standard. The flanges are PN16 (normative EN 1092-1), which makes the GS a suitable product for the heaviest and most challenging of applications. In order to ensure reliable long-term operation and high hydraulic efficiency (up to  $MEI > 0.7$ ), the GS models have two interchangeable bronze wear rings as standard.

## Sealing options

- The seal is available in two different versions:
- SiC/Carbon/EPDM mechanics for liquid temperature up to 120°C
  - A packing that guarantees resistance to wear and ensures that the tightness of the entire system is monitored visually



# One range, multiple solutions

## Type of product

Standardised single-stage centrifugal pumps (EN 733)

## Liquid temperature range

from -10°C to + 90°C for the standard version of the 3-3D-MD SERIES (depending on the model)  
 from -10°C to + 120°C for the Model GS  
 from -20°C to + 120°C for the special versions of the 3-3D-MD SERIES (depending on the model)

## Maximum working pressure

10 bar (16 for Model GS)

## Materials available

Stainless steel AISI 304 for 3 SERIES  
 Stainless steel AISI 316 for 3L SERIES  
 Micro-cast stainless steel AISI 316 for the 3L SERIES 65-250, 3L SERIES 80  
 Cast iron for the 3D SERIES-MD e Model GS

## Regulations

It complies with regulations ErP 547/2012 (index MEI > 0.4),  
 640/2009 (motors in IE3 efficiency class)  
 EN 733

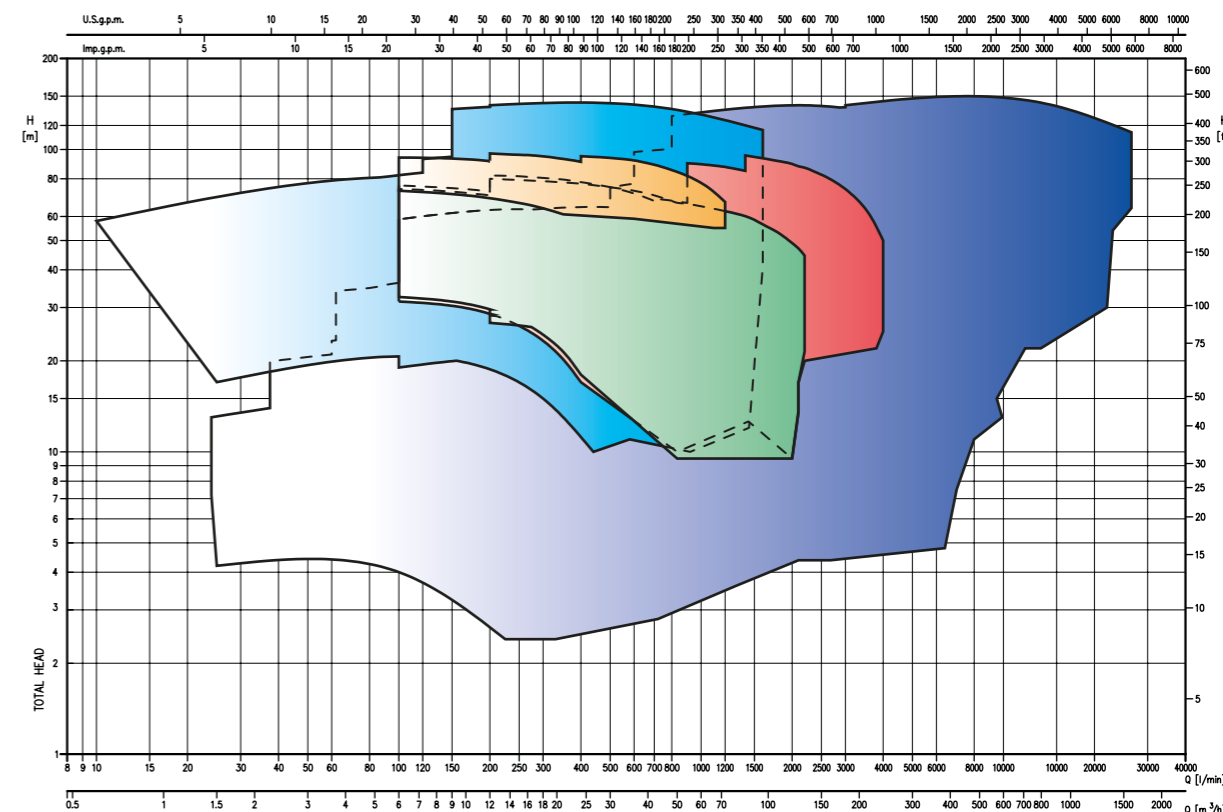
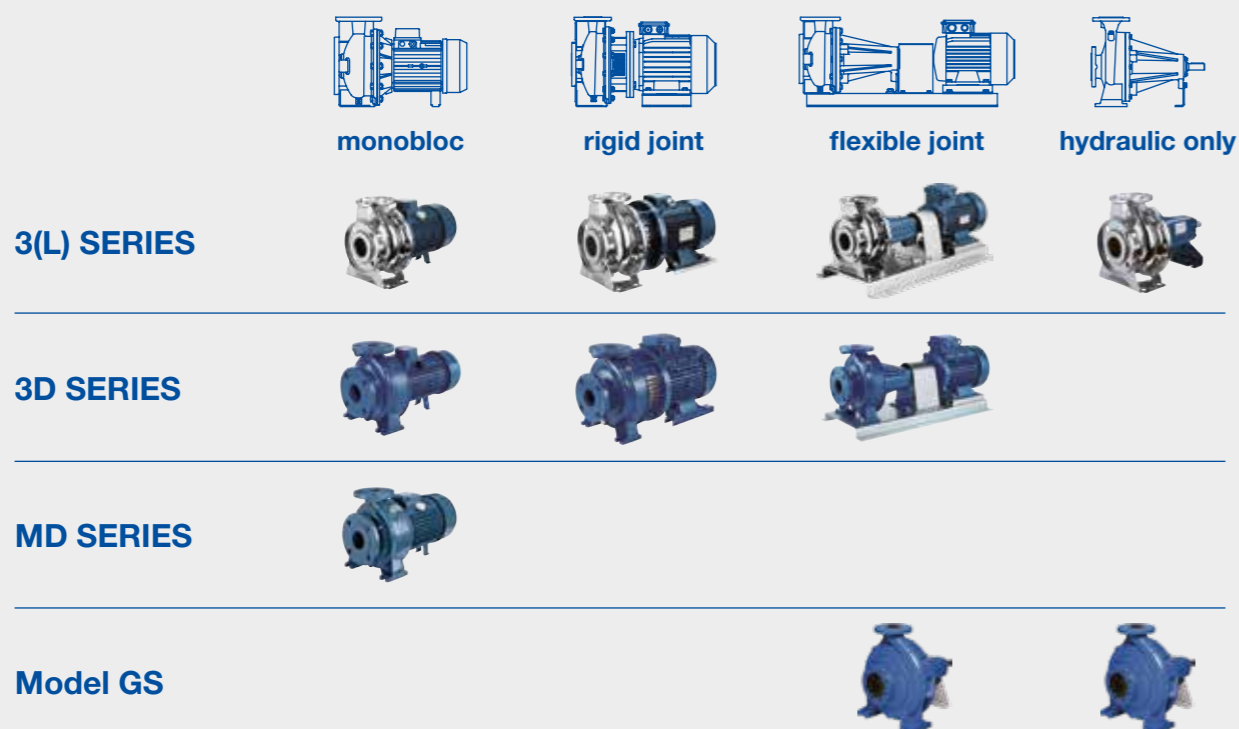

# A driver for your system

Pressure or temperature variations, as well as the variation in the demand for water itself, are situations that commonly occur in water systems, whether this relates to heating systems or in general to distribution and pressurization, irrigation or industrial uses. Responding promptly to these variations means **improving the efficiency** and **reliability** of the entire system. How does this work? EBARA provides a **system that meets these needs**, increases the **versatility** of the plant and offers certain advantages: **E-drive**



Combined with high efficiency motors and thanks to the design and construction of the pump hydraulics EBARA guarantees **high overall efficiency**



**Flexible** and **versatile** solution depending on the system. It is possible to set the inverter with control on the differential pressure, differential temperature and differential flow according to the actual requirement



Remote operation control, either using the ModBus communication protocol, or via the analogue 0-10V and digital analog inputs provided as standard. This makes it a **product that is compatible with the most modern and cutting-edge systems**, in which the interconnection of the various devices is frequently requested



SOFT START and SOFT STOP: ensures starting and stopping controlled by the motor, **increasing reliability and efficiency.**



It offers a multitude of standard controls, which **protect the entire electric pump system:** protection against dry running, overcurrent, overvoltage, undervoltage,  $P_{max}$  protection,  $P_{min}$  protection, etc.



# EZ-finder, more than just a simple selector

**EZ-finder**, a way to look for a model of electric pump? **Much more.** It is the ultimate tool to find and select the right product for your needs. Thanks to the logic of the selector, it is possible to search for a product in **various ways**: according to the duty point, by entering the model name or by selecting the application type. **Simple**, the right product in seconds. EZ-finder is the **ideal tool** available to the installer, the designer or the engineer.

Discover it at the link <https://ezfinder.ebara.com>



Everything  
that you need  
just a click away!  
visit our website [www.ebaraeurope.com](http://www.ebaraeurope.com)



## Data book

Complete technical documentation to be consulted to obtain all the data related to the pumps



## Instruction manual

The manual with all the information needed for correct installation of our pumps



## Kensaku

a system for the selection of spare parts



## Ez-finder

The correct pump selection software for every need  
<https://ezfinder.ebara.com>



## Service

A team of professionals at your disposal to advise you in your choice of pump and to offer post sale assistance

# EBARA sales network

## EUROPE

**EBARA Pumps Europe S.p.A.**  
Via Torri di Confine 2/1 int. C  
36053 Gambellara (Vicenza), Italy  
Phone +39 0444 706811  
Fax +39 0444 405811  
[www.ebaraeurope.com](http://www.ebaraeurope.com)

Italian Sales (for order only):  
e-mail: [ordini@ebaraeurope.com](mailto:ordini@ebaraeurope.com)

Export Sales (for order only):  
e-mail: [exportsales@ebaraeurope.com](mailto:exportsales@ebaraeurope.com)

Technical Customer Service (TCS):  
e-mail: [tcs@ebaraeurope.com](mailto:tcs@ebaraeurope.com)  
Phone +39 0444 706869/902/923/833

Marketing:  
e-mail: [marketing@ebaraeurope.com](mailto:marketing@ebaraeurope.com)

**EBARA Pumps Europe S.p.A. GERMANY**  
Elisabeth-Selbert-Straße 2  
63110 Rodgau, Germany  
Phone +49 (0) 6106-660 99-0  
Fax +49 (0) 6106-660 99-45  
e-mail: [info@ebara.de](mailto:info@ebara.de)

**EBARA Pumps Europe S.p.A. UNITED KINGDOM**  
Unit A, Park 34  
Collett Way - Didcot  
Oxfordshire - OX11 7WB, United Kingdom  
Phone +44 1895 439027 - Fax +44 1235 815770  
e-mail: [mktguk@ebaraeurope.com](mailto:mktguk@ebaraeurope.com)

**EBARA Pumps Europe S.p.A. FRANCE**  
555, Rue Juliette Recamier  
69970 Chaponnay, France  
Phone +33 4 72769482  
Fax +33 805101071  
e-mail: [mktgfr@ebaraeurope.com](mailto:mktgfr@ebaraeurope.com)

**EBARA POMPYS POLSKA Sp. z o.o.**  
ul. Działkowa 115 A  
02-234 Warszawa, Poland  
Phone +48 22 3909920  
Fax +48 22 3909929  
e-mail: [mktgpl@ebaraeurope.com](mailto:mktgpl@ebaraeurope.com)

**EBARA Pumps RUS Ltd.**  
Prospekt Andropov 18, building 7, floor 11  
115432 Moscow  
Phone +7 499 6830133  
e-mail: [mktgrus@ebaraeurope.com](mailto:mktgrus@ebaraeurope.com)

**EBARA PUMPS IBERIA, S.A.**  
Poligono Ind. La Estación  
C/Cormoranes 6-8  
28320 Pinto (Madrid), Spain  
Phone +34 916.923.630  
Fax +34 916.910.818  
e-mail: [marketing@ebara.es](mailto:marketing@ebara.es)

## MIDDLE EAST

**EBARA Pumps Middle East FZE**  
P.O. BOX 61383  
Jebel Ali, Dubai, UAE  
Phone +971 4 8838889  
Fax +971 4 8835307  
e-mail: [info@ebarame.ae](mailto:info@ebarame.ae)

**EBARA PUMPS SAUDI ARABIA LLC**  
St. 98, Dammam Second Industrial City, P.O.Box.  
9210,  
Dammam 34333, Kingdom of Saudi Arabia  
Phone 966-138022014

## ASIA AND SOUTH-EAST ASIA

**EBARA Corporation**  
11-1, Haneda Asahi-cho, Ohta-ku,  
Tokyo 144-8510, Japan  
Phone +81 3 3743-6111  
Fax +81 3 5736 3100  
[www.ebara.co.jp](http://www.ebara.co.jp)

**EBARA Corporation Fujisawa plant**  
4-2-1, Hon-Fujisawa, Fujisawa-shi.  
Kanagawa 251-8502, Japan  
Phone +81-466-83-8111  
Fax +81-466-81-2164

**EBARA Machinery (CHINA) CO., Ltd.**  
Room No.303, Beijing Fortune Plaza, No.7  
Dongsanhuan Zhong Road, Chaoyang District  
Beijing, 100020 P. R. China  
Phone 86-10-65309996  
Fax 86-10-6530-8968  
e-mail: [emc@ebara.cn](mailto:emc@ebara.cn)  
[www.ebara.cn](http://www.ebara.cn)

**EBARA Densan (Qingdao) Technology Co., Ltd.**  
No.88, Wangsha Road, Chengyang Qingdao,  
Shandong Province, P.R.China  
Phone 86-532-8965-3382  
Fax 86-532-8965-3379  
[www.edq-ebara.com](http://www.edq-ebara.com)

**EBARA-Densan Taiwan Manufacturing Co., Ltd.**  
No.7, Nan-Yuen 2nd Road, Chung Li City,  
Tao Yuen Hsien, Taiwan  
Phone 886-3-451-5881  
Fax 886-3-452-7904  
[www.ebara.com.tw](http://www.ebara.com.tw)

**EBARA Thailand Limited**  
3rd Floor Achme Build. 125 Phetchburi Road  
Tungphayathai, Rajthevee, Bangkok 10400, Thailand  
Phone 66-2-216-4935  
Fax 66-2-216-4937  
e-mail: [info@ebara.co.th](mailto:info@ebara.co.th)  
[www.ebara.co.th/index.php/en/](http://www.ebara.co.th/index.php/en/)

**EBARA Fluid Machinery Korea Co., Ltd.**  
3rd Fl. Hyun-Seok Tower, 50,  
Seolleung-Ro 93-Gil, Gangnam-Gu  
Seoul, 135-513 Korea  
Phone 82 70 43621100  
Fax 82 70 82302030  
e-mail: [nishikura.ryutarou@efmk-ebara.com](mailto:nishikura.ryutarou@efmk-ebara.com)

**EBARA Pumps Philippines, Inc.**  
Canlubang Industrial Estate,  
Cabuyao 4025, Laguna, Philippines  
Phone 0063-49-549-1806  
Fax 0063-49-549-1915  
e-mail: [marketing@ebaraphilippines.com](mailto:marketing@ebaraphilippines.com)  
[www.ebaraphilippines.com.ph](http://www.ebaraphilippines.com.ph)

**P.T. EBARA Indonesia**  
Jl. Raya Jakarta - Bogor Km. 32  
Desa Curug, Cimanggis-Depok  
Jawa Barat, 16953 Indonesia  
Phone ( 62-21) 874 0852-53  
Fax ( 62-21) 874 0033  
e-mail: [marketing@ebaraIndonesia.com](mailto:marketing@ebaraIndonesia.com)  
[www.ebaraIndonesia.com](http://www.ebaraIndonesia.com)

**EBARA Pumps Malaysia Sdn. Bhd**  
6, Jalan TP3, UEP Subang Jaya Industrial Park,  
47620, Subang Jaya, Selangor, Malaysia.  
Phone 603-8023 6622  
Fax 603-8023 9355  
e-mail: [sales@ebara.com.my](mailto:sales@ebara.com.my)  
[www.ebara.com.my](http://www.ebara.com.my)

**EBARA Engineering Singapore Pte. Ltd.**  
No 1, Tuas Link 2, Singapore 638550  
Phone 65-6862-3536  
Fax 65-6861-0589  
e-mail: [stdpump@ebarnet.com.sg](mailto:stdpump@ebarnet.com.sg)  
[www.ebara.com.sg](http://www.ebara.com.sg)

**EBARA MACHINERY INDIA PRIVATE LIMITED**  
#133, 1st Floor, Velachery Main Road, Guindy,  
Chennai 600 032, India  
Phone 91-755-0089388

**EBARA Vietnam Pump Company Limited**  
Lai Cach Industrial Zone, Lai Cach Town,  
Cam Giang District,  
Hai Duong Province, Vietnam  
Tel 84-2203-850182  
Fax 84-2203-850180  
e-mail: [info@evpc-vn.com](mailto:info@evpc-vn.com)  
[www.ebarapump.com.vn/en/](http://www.ebarapump.com.vn/en/)

## AMERICA

**EBARA PUMPS AMERICAS CORPORATION**  
1651 Cedar Line Drive  
Rockhill, South Carolina 29730 U.S.A.  
Phone 803 327-5005  
Fax 803 327-5097  
e-mail: [info@pumpsebara.com](mailto:info@pumpsebara.com)  
[www.pumpsebara.com](http://www.pumpsebara.com)

**EBARA Industrias Mecanicas & Comercio Ltda. (Brazil)**  
Rua Joaquim Marques de Figueiredo, 2-31,  
Distrito Industrial, CEP 17034-290, Bauru, SP, Brasil  
Phone +55 14 4009-0000  
Fax +55 14 4009-0044  
e-mail: [assistencia@ebara.com.br](mailto:assistencia@ebara.com.br)  
[www.ebara.com.br/ebara/pt/index.php](http://www.ebara.com.br/ebara/pt/index.php)

**Thebe Bombas Hidraulicas S.A.**  
Avenida Manoel Gomes Casaca, 840 Parque Industrial,  
Vargem Grande do Sul City, Sao Paulo State, CEP:  
13.880-970, Brazil  
Phone 55-19-3641-9100  
Fax 55-19-3641-9114  
[www.thebe.com.br](http://www.thebe.com.br)

**EBARA Bombas Colombia S.A.S.**  
Autopista Medellin km 7 Celta Trade Park Bodega  
02 Lote 116 Funza, Republica de Colombia  
Phone 57-11-826-9865

## AFRICA

**EBARA PUMPS SOUTH AFRICA (PTY) LTD**  
26 Kyalami Boulevard, Kyalami Business Park,  
1684, Midrand, Gauteng  
South Africa  
Phone: +27 11 466 1844  
Fax: +27 11 466 1933

## OCEANIA

**EBARA Pumps Australia Pty. Ltd.**  
7, Holloway Drive  
Bayswater 3153 Victoria, Australia  
Phone 0061-3-97613033  
Fax 0061-3-97613044  
e-mail: [berrett@ebara.com.au](mailto:berrett@ebara.com.au)  
[sales@ebara.com.au](mailto:sales@ebara.com.au)  
[www.ebara.com.au/index.html](http://www.ebara.com.au/index.html)



Japanese Technology since 1912

[www.ebara-europe.com](http://www.ebara-europe.com)



**EBARA Pumps Europe S.p.A.**

Via Torri di Confine 2/1 int. C  
36053 Gambellara (Vicenza), Italy  
Phone +39 0444 706811  
Fax +39 0444 405811  
ebara\_pumps@ebaraeurope.com  
www.ebaraeurope.com

**EBARA Corporation**

11-1, Haneda Asahi-cho, Ohta-ku,  
Tokyo 144-8510  
Japan  
Phone +81 3 6275 7598  
Fax +81 3 5736 3193  
www.ebara.com

